

ADAPTER 제품

Adapter	56
Adapter 접속부 형상 일람표	57



설치방법 P.91

● 사양

재질 : Steel (전기아연도금 유색 Chromate 처리, SUS304, SUS316)

● 사용조건

적용유체 : 광물성일반작동유

최고사용압력 : G 나사측 및 R 나사측의 Size에 의존합니다.

이경 Size에 대해서는 큰 측의 Size에 의존합니다.

(기기접속측 관용 Taper 나사 Type 및 중간접속 Type)

02~08 : 35.0MPa

12 : 27.5MPa

16 : 20.5MPa

(기기접속측 관용평행나사 Type)

04~12 : 21.0MPa

16 : 10.5MPa

사용온도범위 : (기기접속측 관용 Taper 나사 Type 및 중간접속 Type) -55°C~+120°C

(기기접속측 관용평행나사 Type) -30°C~+100°C

품번표시예

010-04-04- (S)

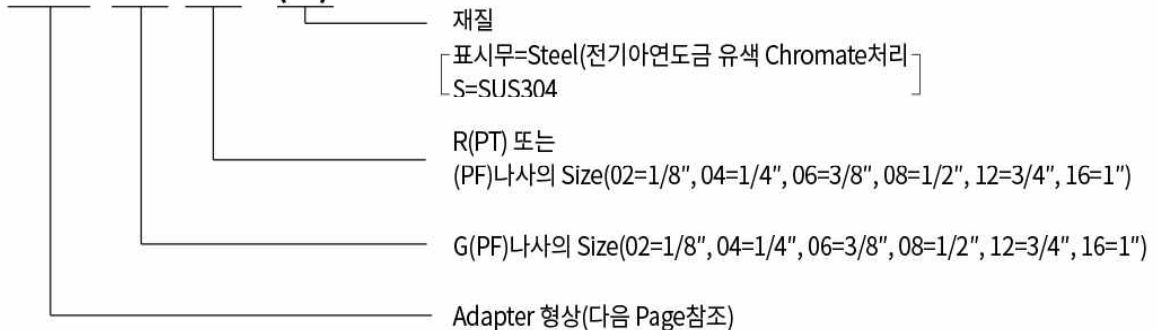



Adapter 접속부 형상 일람표

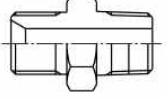
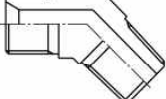
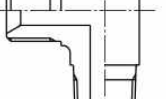
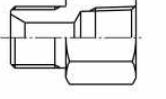
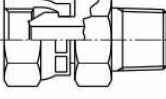

기기접속측 관용 Taper 나사 Type(30°암Seat형상)

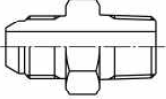
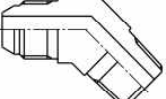
Straight Type	45°Elbow Type	90°Elbow Type	암나사 Straight Type	관용평행 수나사 Type
110	145	190	130	060
				

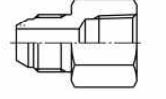
기기접속측 관용 Taper 나사 Type(30°수Seat형상)

Straight Type	45°Elbow Type	90°Elbow Type	암나사 Straight Type
010	045	090	030
			

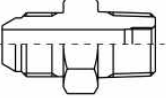
기기접속측 관용 Taper 나사 Throttle Type(30°수Seat형상)

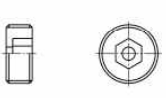
Straight Type	90°Elbow Type	Throttle용 Bolt
010-001	090-001	007
		

중간접속 Type(30°수Seat형상)

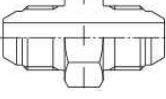
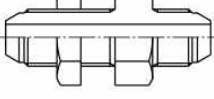
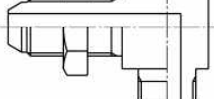
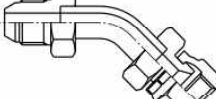
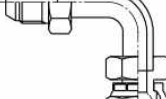
Straight Type	Pannel Touch Type	Pannel Touch 90°Straight Type	45°Bend Type	90°Bend Type
150	020	025	064	069
				

☞ 기타 형상에 관해서는 별도로 문의하여 주십시오.



기기접속측 관용 Taper 나사 Type(30°암Seat형상)

110

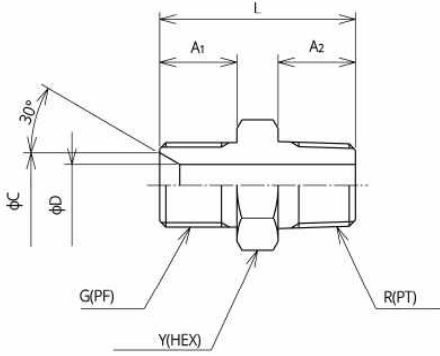

품번	G	R	A1	A2	C	최소내경 φD	L	Y (HEX)	질량 (g)
110-02-02	1/8	1/8	10	10	7.0	3.0	28	14	20
110-02-04	1/8	1/4	10	13	7.0	3.0	31	17	30
110-04-02	1/4	1/8	13	10	9.0	5.5	31	19	30
110-04-04	1/4	1/4	13	13	9.5	5.0	34	19	35
110-04-06	1/4	3/8	13	15	11.0	5.5	36	22	50
110-06-04	3/8	1/4	15	13	12.5	5.0	36	22	50
110-06-06	3/8	3/8	15	15	12.5	8.0	38	22	55
110-06-08	3/8	1/2	15	18	12.5	8.0	43	27	90
110-08-06	1/2	3/8	18	15	15.5	11.0	43	27	90
110-08-08	1/2	1/2	18	18	16.0	11.0	46	27	100
110-08-12	1/2	3/4	18	20	15.5	10.0	50	36	165
110-12-08	3/4	1/2	20	18	21.0	16.0	50	36	165
110-12-12	3/4	3/4	20	20	21.5	16.0	52	36	175
110-12-16	3/4	1	20	22	21.5	16.0	54	41	235
110-16-12	1	3/4	22	20	27.5	22.0	56	41	235
110-16-16	1	1	22	22	27.5	22.0	57	41	245

- 재질 : Steel
- 표면처리 : 전기아연도금 유색 Chromate처리

Stainless Type

품번	G	R	A1	A2	C	최소내경 φD	L	Y (HEX)	질량 (g)
110-02-02-S	1/8	1/8	10	10	7.0	3.0	28	14	20
110-04-04-S	1/4	1/4	13	13	9.5	5.0	34	19	35
110-06-06-S	3/8	3/8	15	15	12.5	8.0	38	22	55
110-08-08-S	1/2	1/2	18	18	16.0	11.0	46	27	100
110-12-12-S	3/4	3/4	20	20	21.5	16.0	52	36	175
110-16-16-S	1	1	22	22	27.5	22.0	57	41	245

- 재질 : Stainless Steel SUS304

적용 Hose 금구 : SF, SL, SF45, SF90, AF45,
AF90, CF, F

145

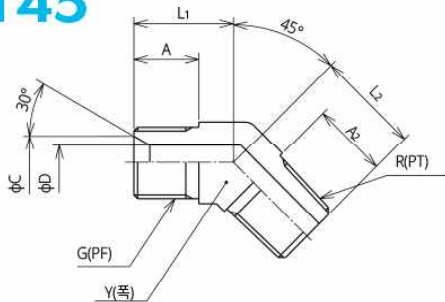

품번	G	R	A1	A2	C	최소내경 φD	L1	L2	Y (HEX)	질량 (g)
145-02-02	1/8	1/8	14	14	7.0	3.0	18	18	14	20
145-02-04	1/8	1/4	10	13	7.0	3.0	18	20	17	35
145-04-02	1/4	1/8	13	14	9.0	5.5	19	20	17	36
145-04-04	1/4	1/4	13	14	9.0	5.5	19	20	17	40
145-04-06	1/4	3/8	13	17.5	9.0	5.5	18	24	19	55
145-06-04	3/8	1/4	15	14	12.5	8.0	23	21	19	57
145-06-06	3/8	3/8	15	15	12.5	8.0	23	24	19	65
145-06-08	3/8	1/2	15	18	12.5	8.0	23	27	24	99
145-08-06	1/2	3/8	18	15	16.0	11.0	26	24	24	95
145-08-08	1/2	1/2	18	22	15.5	11.0	26	27	24	100
145-08-12	1/2	3/4	18	20	16.0	11.0	26	32	30	170
145-12-08	3/4	1/2	20	18	21.5	16	32	27	30	170
145-12-12	3/4	3/4	20	20	21.5	16.0	32	32	30	190
145-12-16	3/4	1	20	22	21.5	16.0	32	34	36	264
145-16-12	1	3/4	22	20	27.5	22	35	32	36	250
145-16-16	1	1	22	22	28.0	22.0	35	34	36	275

- 재질 : Steel
- 표면처리 : 전기아연도금 유색 Chromate처리

적용 Hose 금구 : SF, SL, SF45, SF90, AF45,
AF90, CF, F

기기접속측 관용 Taper 나사 Type(30°암Seat형상)

190

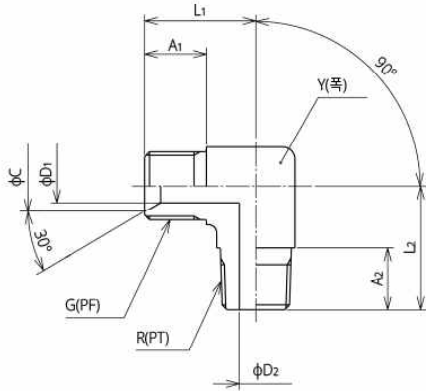

품번	G	R	A1	A2	C	D1	D2	L1	L2	Y (HEX)	질량 (g)
190-02-02	1/8	1/8	9	14	7.0	3.0	4.0	17.5	22.0	14	30
190-02-04	1/8	1/4	10	13	7.0	3.0	5.0	20.0	26.5	17	50
190-04-02	1/4	1/8	13	10	9.5	6.0	4.0	24.6	19.5	17	45
190-04-04	1/4	1/4	13	13	9.5	5.0	5.0	23.0	26.5	17	50
190-04-06	1/4	3/8	13	18	9.0	5.5	8.0	25.0	30.0	19	80
190-06-04	3/8	1/4	15	16	12.5	8.0	5.5	27.0	28.0	19	75
190-06-06	3/8	3/8	15	15	12.5	8.0	8.0	27.0	30.0	19	145
190-06-08	3/8	1/2	15	22	12.5	8.0	8.0	27.5	38.0	24	140
190-08-06	1/2	3/8	18	20	15.5	11.0	8.0	31.0	32.0	24	140
190-08-08	1/2	1/2	18	18	16.0	11.0	11.0	30.5	38.0	24	165
190-08-12	1/2	3/4	18	24	15.5	11.0	11.0	34.0	43.0	30	250
190-12-08	3/4	1/2	20	22	21.0	16.0	11.0	36.0	41.0	30	250
190-12-12	3/4	3/4	20	20	21.5	16.0	16.0	36.0	43.0	30	265
190-12-16	3/4	1	20	22	21.5	16.0	22.0	42.0	46.0	36	400
190-16-12	1	3/4	22	20	27.5	22.0	16.0	42.0	43.0	36	400
190-16-16	1	1	22	27	27.5	22.0	22.0	42.0	46.0	36	460

- 재질 : Steel
- 표면처리 : 전기아연도금 유색 Chromate처리

Stainless Type

품번	G	R	A1	A2	C	D1	D2	L1	L2	Y (HEX)	질량 (g)
190-02-02-S	1/8	1/8	9	14	7.0	3.0	4.0	17.5	22.0	14	30
190-04-04-S	1/4	1/4	13	13	9.5	5.0	5.0	23.0	26.5	17	50
190-06-06-S	3/8	3/8	15	15	12.5	8.0	8.0	27.0	30.0	19	145
190-08-08-S	1/2	1/2	18	18	16.0	11.0	11.0	30.5	38.0	24	165
190-12-12-S	3/4	3/4	20	20	21.5	16.0	16.0	36.0	43.0	30	265
190-16-16-S	1	1	22	27	27.5	22.0	22.0	42.0	46.0	36	460

- 재질 : Stainless Steel SUS304

적용 Hose 금구 : SF, SL, SF45, SF90, AF45, AF90, CF, F

130

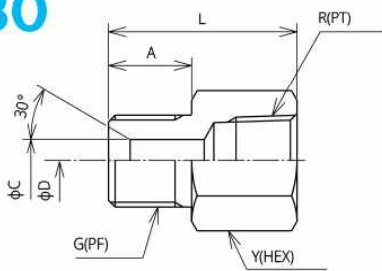

품번	G	R	A	C	최소내경 φD	L	Y (HEX)	질량 (g)
130-02-02	1/8	1/8	10	7.0	3.0	25.0	14	18
130-04-04	1/4	1/4	13	9.0	5.5	30.0	19	36
130-06-06	3/8	3/8	15	12.5	8.0	34.0	22	52
130-08-08	1/2	1/2	18	15.5	11.0	40.0	27	88
130-12-12	3/4	3/4	20	21.0	16.0	45.0	36	175
130-16-16	1	1	22	28.0	22.0	50.0	41	221

- 재질 : Steel
- 표면처리 : 전기아연도금 유색 Chromate처리

적용 Hose 금구 : SA, SF, SL, SF45, SF90, AF45, AF90, CA, CF, A, F

060

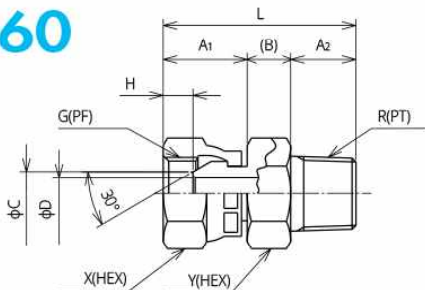

품번	G	R	A1	A2	B	C	최소내경 φD	H	L	X (HEX)	Y (HEX)	질량 (g)
060-02-02	1/8	1/8	16.0	10.5	8.0	4.0	2.8	3.0	34.5	14	14	25
060-04-04	1/4	1/4	17.0	13.5	8.0	7.0	5.0	5.5	38.0	19	19	50
060-06-06	3/8	3/8	19.0	15.0	10.0	7.1	7.2	6.5	44.0	22	22	80
060-08-08	1/2	1/2	23.5	18.0	10.0	13.2	11.0	9.5	51.5	27	27	115
060-12-12	3/4	3/4	23.5	21.0	12.0	19.0	16.0	9.5	56.5	36	36	220
060-16-16	1	1	27.2	23.0	13.0	25.4	21.5	10.0	63.2	41	41	300

- 재질 : Steel
- 표면처리 : 전기아연도금 유색 Chromate처리

적용 Hose 금구 : SC

기기접속측 관용 Taper 나사 Type(30°수Seat형상)

010

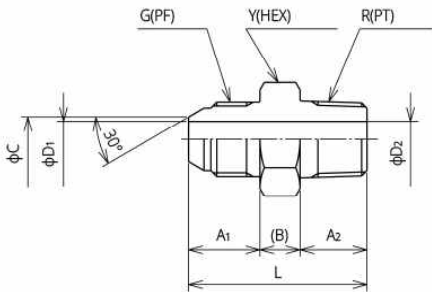

품번	G	R	A1	A2	C	D1	D2	L	Y (HEX)	질량 (g)
010-02-02	1/8	1/8	12	10	4.5	3.0	3.0	30	14	20
010-02-04	1/8	1/4	12	13	4.5	3.0	5.5	34	17	30
010-04-02	1/4	1/8	14	10	7.5	5.5	3.0	32	19	30
010-04-04	1/4	1/4	14	13	7.5	5.5	5.5	35	19	35
010-04-06	1/4	3/8	14	15	7.5	5.5	8.0	37	22	50
010-06-04	3/8	1/4	16	13	10.0	8.0	5.5	39	22	50
010-06-06	3/8	3/8	16	15	10.0	8.0	8.0	40	22	55
010-06-08	3/8	1/2	16	18	10.0	8.0	11.0	44	27	85
010-08-06	1/2	3/8	19	15	13.0	11.0	8.0	44	27	85
010-08-08	1/2	1/2	19	18	13.0	11.0	11.0	47	27	95
010-08-12	1/2	3/4	19	20	13.0	11.0	16.0	53	36	160
010-12-08	3/4	1/2	21	18	19.0	16.0	11.0	51	36	160
010-12-12	3/4	3/4	21	20	19.0	16.0	16.0	53	36	170
010-12-16	3/4	1	21	22	19.0	16.0	22.0	56	41	230
010-16-12	1	3/4	23	20	25.0	22.0	16.0	56	41	230
010-16-16	1	1	23	22	25.0	22.0	22.0	58	41	235

- 재질 : Steel
- 표면처리 : 전기아연도금 유색 Chromate처리

Stainless Type

품번	G	R	A1	A2	C	D1	D2	L	Y (HEX)	질량 (g)
010-02-02-S	1/8	1/8	12	10	4.5	3.0	3.0	30	14	20
010-04-04-S	1/4	1/4	14	13	7.5	5.5	5.5	35	19	35
010-06-06-S	3/8	3/8	16	15	10.0	8.0	8.0	40	22	55
010-08-08-S	1/2	1/2	19	18	13.0	11.0	11.0	47	27	95
010-12-12-S	3/4	3/4	21	20	19.0	16.0	16.0	53	36	170
010-16-16-S	1	1	23	22	25.0	22.0	22.0	58	41	235

- 재질 : Stainless Steel SUS304

적용 Hose 금구 : SE, SLE, SE45, SE90, AE45, AE90, CE, E

045

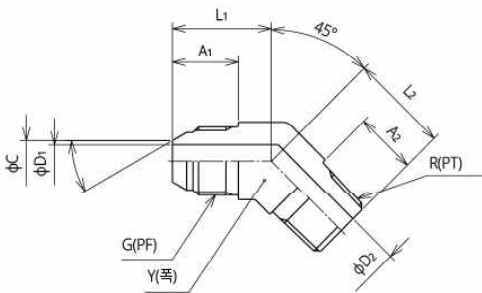

품번	G	R	A1	A2	C	D1	D2	L1	L2	Y (HEX)	질량 (g)
045-02-02	1/8	1/8	12	10.0	4.5	3.0	3	18	18	14	20
045-02-04	1/8	1/4	12	13.0	4.5	3.0	5	20	20	17	35
045-04-02	1/4	1/8	16	14.0	7.5	5.5	3	22	18	17	35
045-04-04	1/4	1/4	14	13.0	7.5	5.0	5	22	20	17	40
045-04-06	1/4	3/8	16	17.5	7.5	5.5	8	22	24	19	60
045-06-04	3/8	1/4	16	13.0	10.0	8.0	5	24	20	19	60
045-06-06	3/8	3/8	16	15.0	10.0	8.0	8	24	24	19	65
045-06-08	3/8	1/2	17	22.0	10.0	8.0	11	24	27	24	90
045-08-06	1/2	3/8	20	17.5	13.0	11.0	8	27	24	24	90
045-08-08	1/2	1/2	19	18.0	13.0	11.0	11	27	27	24	100
045-08-12	1/2	3/4	20	23.0	13.0	11.0	16	27	32	30	160
045-12-08	3/4	1/2	21	22.0	19.0	16.0	11	32	27	30	170
045-12-12	3/4	3/4	21	23.0	19.0	16.0	16	32	32	30	190
045-12-16	3/4	1	21	26.0	19.0	16.0	22	32	34	36	265
045-16-12	1	3/4	23	23.0	25.0	22.0	16	35	32	36	265
045-16-16	1	1	23	22.0	25.0	22.0	22	35	34	36	295

- 재질 : Steel
- 표면처리 : 전기아연도금 유색 Chromate처리

Stainless Type

품번	G	R	A1	A2	C	D1	D2	L1	L2	Y (HEX)	질량 (g)
045-02-02-S	1/8	651/8	12	10.0	4.5	3.0	3	18	18	14	20
045-04-04-S	1/4	1/4	14	13.0	7.5	5.0	5	22	20	17	40
045-06-06-S	3/8	3/8	16	15.0	10.0	8.0	8	24	24	19	65
045-08-08-S	1/2	1/2	19	18.0	13.0	11.0	11	27	27	24	100
045-12-12-S	3/4	3/4	21	23.0	19.0	16.0	16	32	32	30	195
045-16-16-S	1	1	23	22.0	25.0	22.0	22	35	34	36	295

- 재질 : Stainless Steel SUS304

적용 Hose 금구 : SE, SLE, SE45, SE90, AE45, AE90, CE, E

기기접속측 관용 Taper 나사 Type(30°수Seat형상)

090

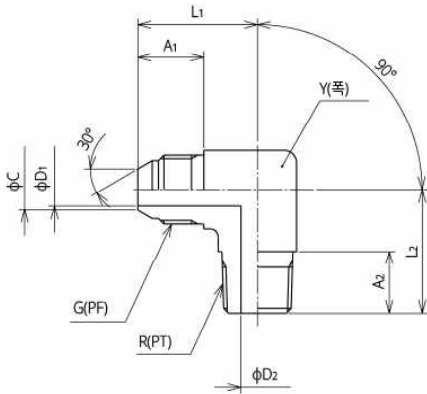

품번	G	R	A1	A2	C	D1	D2	L1	L2	Y (HEX)	질량 (g)
090-02-02	1/8	1/8	14	12	4.5	3.0	4	21.5	22.0	14	30
090-02-04	1/8	1/4	12	13	4.5	3.0	5	23.0	26.5	17	45
090-04-02	1/4	1/8	14	10	7.5	5.0	3	24.0	22.5	17	45
090-04-04	1/4	1/4	14	13	7.5	5.0	5	24.0	26.5	17	50
090-04-06	1/4	3/8	16	18	7.5	5.5	8	29.0	30.0	19	80
090-06-04	3/8	1/4	16	13	10.0	8.0	5	29.0	26.5	19	75
090-06-06	3/8	3/8	16	15	10.0	8.0	8	29.0	30.0	19	80
090-06-08	3/8	1/2	16	18	10.0	8.0	11	29.0	38.0	24	145
090-08-06	1/2	3/8	20	18	13.0	11.0	8	32.5	30.0	24	140
090-08-08	1/2	1/2	20	22	13.0	11.0	11	32.5	38.0	24	165
090-08-12	1/2	3/4	20	24	13.0	11.0	16	36.0	43.0	30	250
090-12-08	3/4	1/2	21	22	19.0	16.0	11	36.0	38.0	30	250
090-12-12	3/4	3/4	21	20	19.0	16.0	16	36.0	43.0	30	265
090-12-16	3/4	1	23	25	19.0	16.0	22	42.0	46.0	36	400
090-16-12	1	3/4	23	24	25.0	22.0	16	42.0	43.0	36	400
090-16-16	1	1	23	22	25.0	22.0	22	42.0	46.0	36	400

- 재질 : Steel
- 표면처리 : 전기아연도금 유색 Chromate처리

적용 Hose 금구 : SE, SLE, SE45, SE90, AE45, AE90, CE, E

Stainless Type

품번	G	R	A1	A2	C	D1	D2	L1	L2	Y (HEX)	질량 (g)
090-02-02-S	1/8	1/8	14	12	4.5	3.0	4	21.5	22.0	14	30
090-04-04-S	1/4	1/4	14	13	7.5	5.0	5	24.0	26.5	17	50
090-06-06-S	3/8	3/8	16	15	10.0	8.0	8	29.0	30.0	19	80
090-08-08-S	1/2	1/2	19	18	13.0	11.0	11	32.5	38.0	24	165
090-12-12-S	3/4	3/4	21	20	19.0	16.0	16	36.0	43.0	36	265
090-16-16-S	1	1	23	22	25.0	22.0	22	42.0	46.0	41	400

- 재질 : Stainless Steel SUS304

030

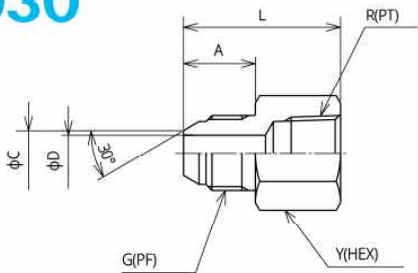

품번	G	R	A	C	최소내경 φD	L	Y (HEX)	질량 (g)
030-02-02	1/8	1/8	12	4.5	3.0	27	14	20
030-04-04	1/4	1/4	14	7.5	5.5	30	19	25
030-06-06	3/8	3/8	16	10.0	8.0	35	22	55
030-08-08	1/2	1/2	19	13.0	11.0	41	27	75
030-12-12	3/4	3/4	21	19.0	16.0	46	36	160
030-16-16	1	1	23	25.0	22.0	51	41	220

- 재질 : Steel
- 표면처리 : 전기아연도금 유색 Chromate처리

적용 Hose 금구 : SE, SLE, SE45, SE90, AE45, AE90, CE, E

Stainless Type

품번	G	R	A	C	최소내경 φD	L	Y (HEX)	질량 (g)
030-02-02-S	1/8	1/8	12	4.5	3.0	27	14	20
030-04-04-S	1/4	1/4	14	7.5	5.5	30	19	25
030-06-06-S	3/8	3/8	16	10.0	8.0	35	22	55
030-08-08-S	1/2	1/2	19	13.0	11.0	41	27	75
030-12-12-S	3/4	3/4	21	19.0	16.0	46	36	160
030-16-16-S	1	1	23	25.0	22.0	51	41	220

- 재질 : Stainless Steel SUS304

기기접속측 관용 Taper 나사 Throttle Type(30°수Seat형상)

010 Throttle

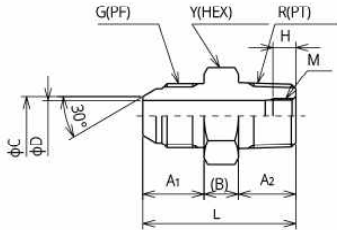

적용 Hose 금구 : SE, SLE, SE45, SE90,
AE45, AE90, CE, E

품번	G	R	A1	A2	B	C	최소 내경 φD	H	L	M	Y (HEX)	질량 (g)
010-04-04-001	1/4	1/4	14	13	8	7.5	5.5	6.0	35	M7×0.75	19	35
010-06-06-001	3/8	3/8	16	15	9	10.0	8.0	6.0	40	M9×0.75	22	55
010-08-08-001	1/2	1/2	19	18	10	13.0	11.0	7.5	47	M12×1	27	90
010-12-12-001	3/4	3/4	21	20	12	19.0	16.0	8.5	53	M17×1	36	170

- 재질 : Steel
- 표면처리 : 전기아연도금 유색 Chromate처리

090 Throttle

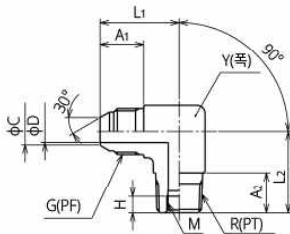

적용 Hose 금구 : SE, SLE, SE45, SE90,
AE45, AE90, CE, E

품번	G	A1	A2	C	최소 내경 φD	H	L1	L2	Y (HEX)	M	질량 (g)
090-04-04-001	1/4	14	13	7.5	5	6.0	24.0	26.5	17	M7×0.75	50
090-06-06-001	3/8	16	15	10.5	8	6.0	29.0	30.0	19	M9×0.75	90
090-08-08-001	1/2	19	18	13.0	11	7.5	32.5	38.0	24	M12×1	145
090-12-12-001	3/4	21	20	19.0	16	8.5	36.0	43.0	30	M17×1	260

- 재질 : Steel
- 표면처리 : 전기아연도금 유색 Chromate처리

고정 Throttle Type용 Bolt

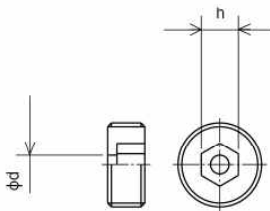

품번	적용 Adapter 1	적용 Adapter 2	h	φd	질량 (g)
007-04-0.5	010-04-04-001	090-04-04-001	3	0.5	1.0
007-04-0.7	010-04-04-001	090-04-04-001	3	0.7	1.0
007-04-1.0	010-04-04-001	090-04-04-001	3	1.0	1.0
007-04-1.5	010-04-04-001	090-04-04-001	3	1.5	1.0
007-04-2.0	010-04-04-001	090-04-04-001	3	2.0	1.0
007-06-0.5	010-06-06-001	090-06-06-001	4	0.5	1.5
007-06-0.7	010-06-06-001	090-06-06-001	4	0.7	1.5
007-06-1.0	010-06-06-001	090-06-06-001	4	1.0	1.5
007-06-1.5	010-06-06-001	090-06-06-001	4	1.5	1.5
007-08-0.5	010-08-08-001	090-08-08-001	6	0.5	3.0
007-08-0.7	010-08-08-001	090-08-08-001	6	0.7	3.0
007-08-1.0	010-08-08-001	090-08-08-001	6	1.0	3.0
007-08-1.5	010-08-08-001	090-08-08-001	6	1.5	3.0
007-08-2.0	010-08-08-001	090-08-08-001	6	2.0	3.0
007-08-2.5	010-08-08-001	090-08-08-001	6	2.5	3.0
007-12-1.5	010-12-12-001	090-12-12-001	8	1.5	8.0
007-12-2.0	010-12-12-001	090-12-12-001	8	2.0	8.0
007-12-2.5	010-12-12-001	090-12-12-001	8	2.5	8.0
007-12-3.0	010-12-12-001	090-12-12-001	8	3.0	8.0

- 재질 : Steel
- 표면처리 : 전기아연도금 유색 Chromate처리

중간접속 Type(30°수Seat형상)

150

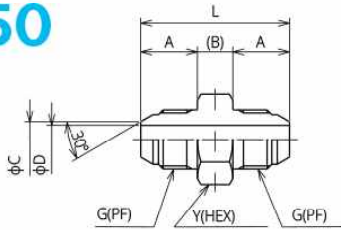

품번	G	A	B	C	최소내경 φD	L	Y (HEX)	질량 (g)
150-02-02	1/8	12	6.5	4.5	3.0	30.5	14	15
150-04-04	1/4	14	8.0	7.5	5.5	36.5	19	50
150-06-06	3/8	16	10.0	10.0	8.0	42.0	22	75
150-08-08	1/2	19	10.0	13.0	11.0	48.0	27	85
150-12-12	3/4	21	12.0	19.0	16.0	54.0	36	160
150-16-16	1	23	13.0	25.0	22.0	59.0	41	230

적용 Hose 금구 : SE, SLE, SE45, SE90,
AE45, AE90, CE, E

- 재질 : Steel
- 표면처리 : 전기아연도금 유색 Chromate처리

020 Pannel Touch

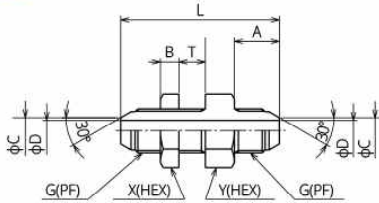

품번	G	A	B	C	최소 내경 φD	L	T (최대 Pannel 두께)	X (HEX)	Y (HEX)	체결 Nut	질량 (g)
020-04-04-001	1/4	14	7	7.5	5	54	10	22	22	NP04	75
020-06-06-001	3/8	17	7	10.0	8	60	10	24	24	NP06	105
020-08-08-001	1/2	19	10	13.0	11	71	10	30	30	NP08	190
020-12-12-001	3/4	21	10	19.0	16	79	10	41	41	NP12	365
020-16-16-001	1	23	12	25.0	22	87	10	46	46	NP16	505

적용 Hose 금구 : SE, SLE, SE45, SE90, AE45, AE90, CE, E

- 재질 : Steel
- 표면처리 : 전기아연도금 유색 Chromate처리

025 Pannel Touch

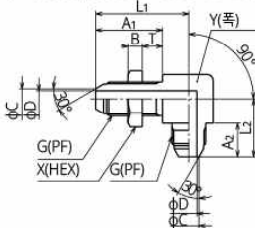

품번	G	A1	A2	B	C	최소 내경 φD	L1	L2	T (최대 Pannel 두께)	X (HEX)	Y (HEX)	체결 Nut	질량 (g)
025-04-04	1/4	32	15	7	7	5.5	45	26.0	10	22	22	NP04	125
025-06-06	3/8	33	16	7	10	8.0	46	28.5	10	24	24	NP06	160
025-08-08	1/2	40	19	10	13	11.0	59	35.0	10	30	30	NP08	320
025-12-12	3/4	41	21	10	19	16.0	41.5	41.5	10	41	41	NP12	685
025-16-16	1	45	23	12	25	22.0	46.0	46.0	10	46	46	NP16	950

적용 Hose 금구 : SE, SLE, SE45, SE90, AE45, AE90, CE, E

- 재질 : Steel
- 표면처리 : 전기아연도금 유색 Chromate처리

064

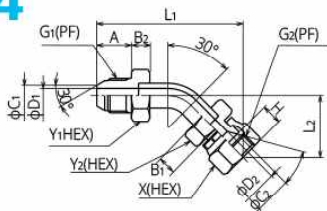

품번	G1	G2	A	B1	B2	C1	C2	D1	D2	H	L1	L2	X (HEX)	Y (HEX)	Pipe Size	질량 (g)
064-04	1/4	1/4	15	8.5	9	9.0	7	5.0	5.0	8.0	62.5	25.5	19	19	φ10×t2	85
064-06	3/8	3/8	17	9.0	9	12.0	10	7.0	7.0	9.7	71.5	30.0	22	22	φ12×t2	120
064-08	1/2	1/2	20	9.5	10	15.5	13	10.0	10.0	12.7	82.0	31.5	27	27	φ15×t2.5	200
064-12	3/4	3/4	21	10.7	11	21.0	19	16.0	16.0	13.3	95.0	39.5	36	36	φ20×t2.5	350
064-16	1	1	23	12.5	12	28.0	25	21.5	21.5	16.7	107.5	46.5	41	41	φ28×t3.5	515

적용 Hose 금구 : SE, SLE, SE45, SE90, AE45, AE90, CE, E

- 재질 : Steel
- 표면처리 : 전기아연도금 유색 Chromate처리

069

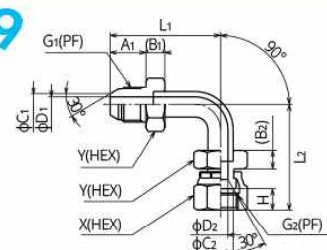

품번	G1	G2	A	B1	B2	C1	C2	D1	D2	H	L1	L2	X (HEX)	Y (HEX)	Pipe Size	질량 (g)
069-04	1/4	1/4	15	8.5	9	9.0	7	5.0	5.0	8.2	46.0	45	19	19	φ10×t2	90
069-06	3/8	3/8	17	9.0	9	12.0	10	7.0	7.0	9.7	52.5	50	22	22	φ12×t2	125
069-08	1/2	1/2	20	9.5	10	15.5	13	10.0	10.0	12.7	62.0	55	27	27	φ15×t2.5	205
069-12	3/4	3/4	21	10.7	11	21.0	19	16.0	16.0	13.3	74.0	76	36	36	φ20×t2.5	375
069-16	1	1	23	12.5	12	28.0	25	21.5	21.5	16.7	82.5	87	41	41	φ28×t3.5	565

적용 Hose 금구 : SE, SLE, SE45, SE90, AE45, AE90, CE, E

- 재질 : Steel
- 표면처리 : 전기아연도금 유색 Chromate처리